

# Tank Fittings

*Beckett*  
TANK ACCESSORIES

## Product Sheet

### Vent Caps

- Available in threaded and slip-on designs
- Slip-on designs solve clearance problems
- Zinc-plated cast iron, zinc-plated steel, zamak, and rust proof aluminum
- Available in sizes from ¾" to 4"
- Each cap includes a screen to prevent insects and debris from entering the vent pipe



#### Zinc-plated Cast Iron Mushroom Vent Caps

Part No.	Description
14021	¾" FPT
14022	1" FPT
14023	1¼" FPT
14024	1½" FPT
14025	2" FPT
14027	3" FPT
14028	4" FPT

FPT = Female Pipe Thread



#### Zinc-plated Steel Slip-on

Part No.	Description
14036	1"
14037	1¼"
14038	1½"
14039	2"



#### Zamak Slip-on

Part No.	Description
14006	¾" – 1"



#### Aluminum Slip-on

Part No.	Description
14009	2"

# Tank Fittings

*Beckett*  
TANK ACCESSORIES

## Product Sheet

### Duplex Tank Bushings

- Available in 3-Way and 4-Way Tap
- Ideal for two line suction and return installations
- Available with or without brass compression fittings

#### 4-Way Tap with Slip-Thru Male Compression Fittings

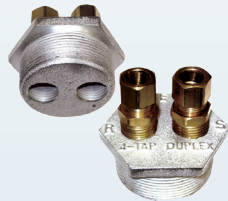

With Fittings	Part No.	MPT	Return	Supply
	14475	2"	3/8"	3/8"
	14476	2"	1/2"	1/2"
	14477	2"	5/8"	5/8"

Bushing Only	Part No.	MPT	FPT
	14475	2"	3/8"
	14476	2"	1/2"
	14477	2"	5/8"

#### 3-Way Tap with Slip-Thru Male Compression Fittings



With Fittings	Part No.	MPT	Return	Supply
	14468	2"	3/8"	3/8"
	14469	2"	3/8"	1/2"
	14470	2"	1/2"	1/2"
	14471	2"	1/2"	5/8"

Bushing Only	Part No.	MPT	FPT
	14472	2"	3/8"
	14473	2"	1/2"

#### 3-Way Tap with Slip-Thru Male Compression Union



With Union	Part No.	MPT	Return	Supply
	14446	1 1/2"	3/8"	3/8"
	14447	2"	3/8"	3/8"
	14448	2"	1/2"	1/2"

#### 3-Way Tap with Double-Compression Nut



With Nut	Part No.	MPT	Return	Supply
	14434	2"	3/8"	3/8"

### Double Tapped Bushings

- Cast iron construction
- Full range of sizes
- Double tapped full FPT thread
- Rugged design with solid hexes for secure wrench grip
- Can be used as reducing bushing for continuous piping

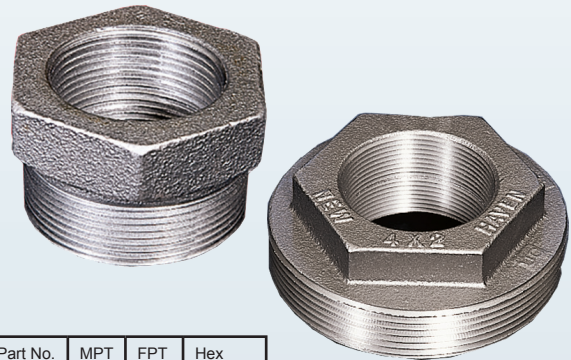

Part No.	MPT	FPT	Hex
14566	1"	1/2"	Outside
14568	1 1/4"	1/2"	Inside
14569	1 1/4"	3/4"	Outside
14570	1 1/4"	1"	Outside
14572	1 1/2"	1/2"	Inside
14573	1 1/2"	3/4"	Inside
14574	1 1/2"	1"	Outside
14575	1 1/2"	1 1/4"	Outside
14576	2"	3/8"	Inside
14577	2"	1/2"	Inside
14578	2"	3/4"	Inside
14579	2"	1"	Inside
14580	2"	1 1/4"	Outside
14581	2"	1 1/2"	Outside
14584	2 1/2"	1 1/4"	Inside

Part No.	MPT	FPT	Hex
14585	2 1/2"	1 1/2"	Inside
14586	2 1/2"	2"	Outside
14588	3"	1"	Inside
14589	3"	1 1/4"	Inside
14590	3"	1 1/2"	Inside
14591	3"	2"	Inside
14592	3"	2 1/2"	Inside
14600	4"	1"	Inside
14601	4"	1 1/4"	Inside
14602	4"	1 1/2"	Inside
14603	4"	2"	Inside
14604	4"	2 1/2"	Outside
14605	4"	3"	Inside
14609	6"	4"	Inside

MPT = Male Pipe Thread, FPT = Female Pipe Thread

For complete listing of all available fittings, see product sheet XXXXXX. For information on all Beckett products, please visit our website.

**R.W. BECKETT CORPORATION**

USA: R.W. Beckett Corporation • ph: (800)645-2876 • fax: (440)327-1064 | Canada: R.W. Beckett Canada Ltd. • ph: (800)665-6972 • fax: (519)763-5656

[www.beckettcorp.com](http://www.beckettcorp.com)