

Illustrations and photographs are only representative.
Some product models may vary.

HI-BOY MULTI-POSITION OIL FURNACE

FEATURES

- **Stainless Steel construction** - Heavy gauge heat exchanger quickly transfers heat to the ambient air
- **Multi-position** - True 4-way multipoise unit that opens-up installation possibilities
- **Low profile** - OMF098 is 40-3/4 inches (1035mm) high and OMF112 is 41-1/2 inches (1054mm) high OMF154 is 47-7/8 inches (1216mm) high
- **Sound attenuator** - High density acoustic wool dampens combustion sound
- **Burners** - Choice of high static pressure oil burners Becket AFG & NX, Riello 40 (Burners must be ordered separately)
- **Inspection port** - External for easy access and sealed - Adjust combustion parameters and simplify inspections
- **Accessories included** - Barometric draft regulator, external filter rack and air filter
- **High quality finish** - High gloss baked
- **Efficiency** - AFUE up to 87.1% Canada, 86.4% US
- **Approved** - For chimney vent and sealed combustion installations

LIMITED WARRANTY *

- Lifetime heat exchanger limited warranty with timely registration
- 5 year parts limited warranty
 - With timely registration, an additional 5 year parts limited warranty
- * For residential applications only. See warranty certificate for complete details and restrictions, including warranty coverage for other applications

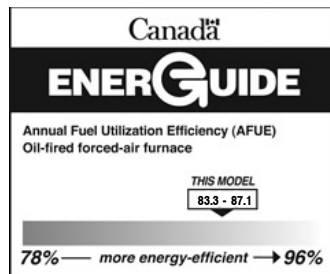

ONLY applies to applications in Canada where the furnace is installed in the conditioned space, per sections 5.35.1.2 and 4.7.1.1 of CSA standard B212 dated October 2000.

Model Number	Input (BTU/h)	Efficiency AFUE		Cooling capacity @ .5 in wc (125 Pa)	Dimensions in(mm) H x W x D†	Shipping Wt. Lbs. (Kg.)
		CANADA	US			
OMF098J10	70,000-98,000	84.0-87.0	83.3-86.4	2.5 Tons	40 3/4 x 16 7/8 x 21 1/2 (1035 x 429 x 546)	125 (57)
OMF112K14	95,200-112,000	85.6-87.1	84.3-85.8	3.5 Tons	41 1/2 x 21 3/4 x 25 3/4 (1054 x 553 x 654)	153 (70)
OMF154L20	126,000-154,000	85.3-87.0	85.0-86.1	5.0 Tons	47-7/8 x 28-1/2 x 25 (1216 x 724 x 635)	200 (90)

† Depth is without the burner

MODEL NUMBER IDENTIFICATION GUIDE

MODEL NUMBER	O	M	F	098	J	10	#	REVISION
FUEL O = Oil								AIR FLOW 10 = 1000 CFM 12 = 1200 CFM 14 = 1400 CFM
PRODUCT GROUP U = Upflow H = Horizontal T = Upflow/Horizontal L = Lo-Boy	D = Downflow C = Downflow/Horizontal M = Multiposition							SUPPLY PLENUM SIZE A = 20 x 20 B = 24 x 24 C = 21 ¹ / ₈ x 21 ¹ / ₂ G = 22 x 30 K = 17 ¹ / ₂ x 19
SERIES F = Front Breech R = Rear Breech V = Variable Motor								INPUT, MBTUH D = 19 x 20 E = 19 x 24 F = 20 x 24 J = 16 x 19 L = 20 x 22

DIMENSIONS AND CLEARANCES

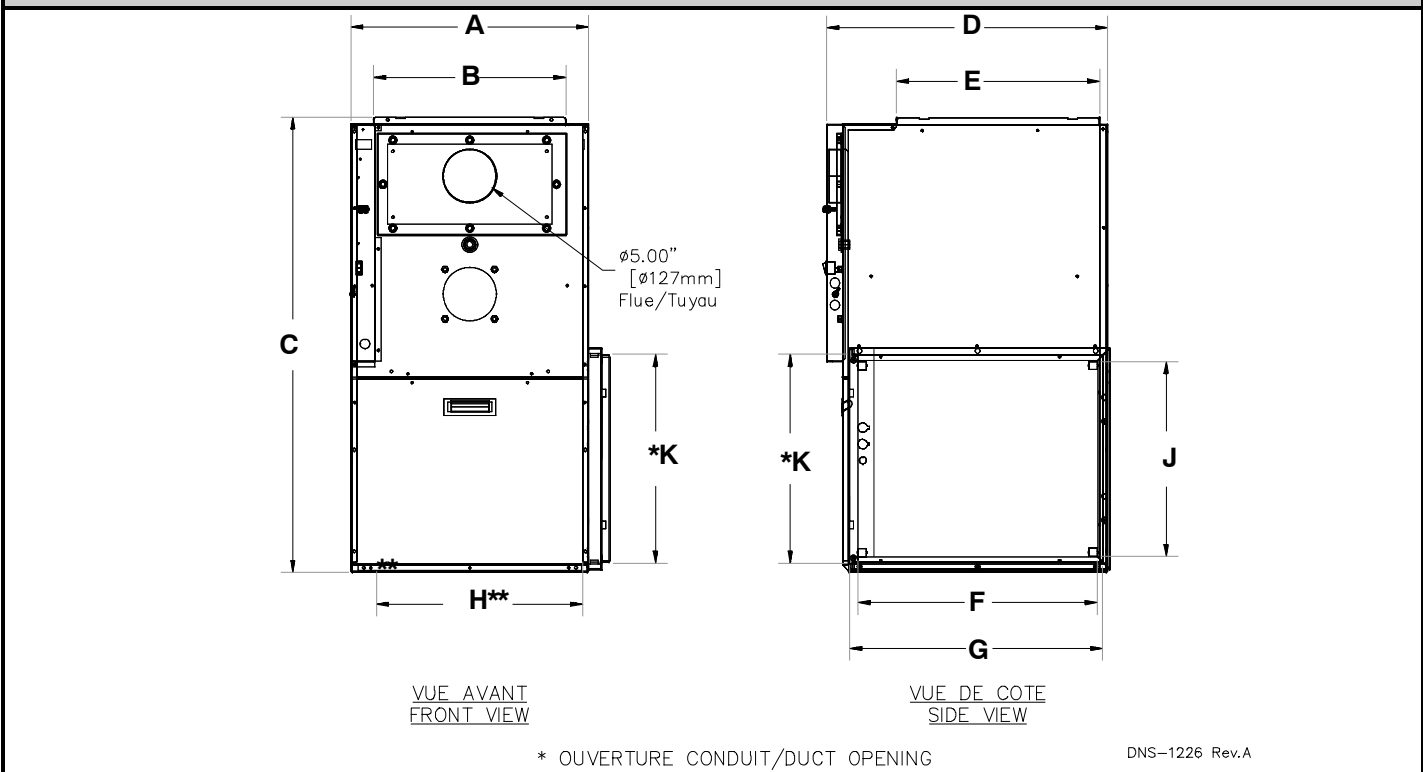

FURNACE DIMENSIONS - in(mm)

OMF	DIMENSIONS									
	A	B	C	D	E	F	G	H	J	K
098	16-7/8(429)	16(406)	40-3/4(1035)	21-1/2(546)	19(483)	17-3/4(451)	19	18-3/4(476)	17-3/4(451)	19(483)
112	21-5/8(550)	17-1/2(444)	41-1/2(1054)	25-1/2(649)	19(483)	21-3/4(552)	23(584)	18-3/4(476)	17-3/4(451)	19(483)
154	23(584)	20(508)	47-7/8(1216)	28-1/2(725)	22(559)	21-3/4(552)	23(584)	25(635)	21-3/4(552)	23(584)

** For the 098, use Floor Return Base (FRB101) accessory to achieve 18-3/4 return air opening.

MINIMUM INSTALLATION CLEARANCES FROM COMBUSTIBLE MATERIALS - in(mm)

Location	Application	Upflow	Downflow	Horizontal
Sides	Furnace ¹	1 (25)	1 (25)	N / A
	Supply plenum - within 6ft (1.8m) of furnace ¹	2 (51)	2 (51)	1 (25)
Bottom	Furnace ² (*use sub-base on combustible floor)	0	2 (51) ⁴	1 (25) ³
Back	OMF098 Furnace (opposite end of burner) ¹	3 (76)	3 (76)	1 (25)
	OMF112 & OMF154 Furnace (opposite end of burner) ¹	3 (76)	3 (76)	3 (76)
Top	Furnace ² or Plenum	N / A	N / A	2 (51)
	OMF098 & OMF154 Horizontal warm air duct - within 6ft (1.8m) of furnace	2 (51)	2 (51)	2 (51)
	OMF112 Horizontal warm air duct - within 6ft (1.8m) of furnace	2 (51)	2 (51)	3 (76)
Flue pipe	Vertically above flue pipe	9 (229)	9 (229)	9 (229)
Front	Furnace (burner end) ¹	18 (457)	18 (457)	18 (457)

¹ Horizontal dimensions

² Vertical dimensions

³ This dimension can be obtained by using Horizontal Flow Base # HFB101

⁴ This dimension can be obtained by using Downflow Base # DFB102 for OMF098 or DFB103 for OMF112 & DFB104 for OMF154

FURNACE SPECIFICATIONS							
Model:	OMF098			OMF112		OMF154	
Rating & Performance							
Firing rate (USGPH)*	0.50	0.60	0.70	0.68	0.80	0.90	1.10
Input (BTU/h)*	70,000	84,000	98,000	95,200	112,000	126,000	154,000
Maximum heating capacity (BTU/h)*	59,200	70,400	80,800	81,200	94,200	107,000	129,000
Heating temperature rise *	31 - 47°C / 55 - 85°F			31 - 42°C / 55 - 75°F		31 - 42°C / 55 - 75°F	
Flue draft with chimney (in. w.c. / Pa)	-0.06 to -0.025 / -14.9 to -6.2			-0.06 to -0.025 / -14.9 to -6.2		-0.06 to -0.035 / -14.9 to -8.7	
Overfire pressure with chimney (in. w.c. / Pa)	-0.035 to +0.010 / -8.7 to +2.5			-0.035 to +0.025 / -8.7 to +6.2		-0.035 to +0.045 / -8.7 to +11.2	
Flue draft with direct vent (in. w.c. / Pa)	+0.05 to +0.20 / +12.5 to +50			+0.03 to +0.15 / +7.5 to +37.5		+0.05 to +0.16 / +12.5 to +40	
Overfire pressure with direct vent (in. w.c. / Pa)	+0.03 to +0.15 / +7.5 to +37.5			+0.05 to +0.17 / +12.5 to +42.3		+0.06 to +0.22 / +14.9 to +54.8	
Beckett Burner, Chimney	AFG70MQSS			AFG70MQSS		N/A	
Burner tube insertion length	1-3/4" (70mm)			1-3/4" (45mm)		N/A	
Head type	2-slot L2 head			2-slot L2 head		N/A	
Nozzle (Delavan)	0.40-60A	0.50-60A	0.60-60B	0.60-60W	0.60-60B	N/A	N/A
Low firing rate baffle	Yes (5580)	Yes (5580)	No	N/A	N/A	N/A	N/A
Pump pressure (PSIG)*	155	145	135	140	150	N/A	N/A
Head/Air setting	4/0	8/0	5/0	10/0	10/0 (Note 1)	N/A	N/A
AFUE % (From CSA B212 standard & Canadian regulation)***	85.6	85.6	84.3	86.3	85.6	N/A	N/A
AFUE % (From ASHRAE 103 standard & US regulation)***	85.2	85.1	83.9	85.3	85.4	N/A	N/A
Beckett Burner, Chimney or Direct Vent	NX56LQ			NX56LQ		NX50LC	
Burner tube insertion length	2-3/4" (70mm)			1-3/4" (45mm)		1-3/4" (45mm)	
Head type	6-slot LQ head			6-slot LQ head		6-slot LC head	
Nozzle (Delavan)	0.40-60W	0.50-60W	0.60-60W	0.60-60A	0.70-60A	0.75-60B	0.90-60B
Low firing rate baffle	Yes (32229)	Yes (32229)	No	N/A	N/A	145	150
Pump pressure (PSIG)*	155	145	135	130	130	145	150
Head/Air setting	2.0	2.75	2.5	3.5	2.5	3.5	4.0
AFUE % (From CSA B212 standard & Canadian regulation)***	86.7	85.7	85.0	87.1	86.6	87.0	85.6
AFUE % (From ASHRAE 103 standard & US regulation)***	86.1	85.4	84.5	85.8	85.3	85.3	85.1
Riello Burner, Chimney	40-F3 with Air Inlet Damper			40-F3 with Air Inlet Damper		F5 with Electric Air Damper	
Burner tube insertion length	2 3/4" (70mm)			2 3/4" (70mm)		2 3/4" (70mm)	
Nozzle (Delavan)	0.40-70A	0.50-70A	0.60-70A	0.60-70A	0.70-70A	0.75-70A	0.90-70A
Pump pressure (PSIG)*	155	145	135	130	130	145	150
Combustion air adjustment (turbulator/damper)	0 / 1.5	0 / 2.5	1 / 3.5	1 / 2.6	2 / 3.1	1.5/2.25	2.5/2.75
AFUE % (From CSA B212 standard & Canadian regulation)***	87.0	86.3	84.9	87.0	86.8	86.6	85.3
AFUE % (From ASHRAE 103 standard & US regulation)***	86.4	85.9	84.5	85.8	85.4	86.0	85.0
Riello Burner, Direct Vent	40-BF3			40-BF5		40-BF5	
Burner tube insertion length	2 3/4" (70mm)			2 3/4" (70mm)		2 3/4" (70mm)	
Nozzle (Delavan)	0.40-70A	0.50-70A	0.60-70A	0.60-70A	0.70-70A	0.75-70A	0.90-70A
Pump pressure (PSIG)*	155	145	135	130	130	145	150
Combustion air adjustment (turbulator/damper)	0 / 3.25	0 / 4	1 / 5.25	0 / 2.75	2 / 3.25	1.0/3.75	3.0/4.25
AFUE % (From CSA B212 standard & Canadian regulation)***	85.6	85.3	84.0	86.7	85.5	86.4	85.7
AFUE % (From ASHRAE 103 standard & US regulation)***	85.1	85.0	83.3	85.5	85.3	86.1	85.0
Electrical System							
Volts - Hz - Phase	115 - 60 - 1			115 - 60 - 1		115 - 60 - 1	
Rated current (Amps)	12.2			12.6		16.9	
Minimum ampacity for wire sizing (Amps)	13.7			15.2		19.5	
Max. fuse size (Amps)	15			20		20	
Control Transformer (VA)	40			40		40	
External control power available	Heating (VA)			40		40	
	Cooling (VA)			30		30	
Blower Data, Side Air Return							
Heating blower speed at 0.25 in. w.c. (62 Pa)	Med-Low	Med-High	High	Med-Low	Med-High	Med-Low	Med-High
Heating blower speed at 0.50 in. w.c. (125 Pa)	Med-Low	Med-High	High	Med-Low	Med-High	Med-Low	Med-High
Heating Air flow at 0.2 in. w.c. (60 Pa) - side air return - CFM(L/s)	850 (401)	1050 (496)	1165 (550)	1180 (597)	1320 (623)	1515 (715)	1875(885)
Cooling Air flow at 0.50 in. w.c. (125 Pa) - side air return - CFM(L/s)	795 (375)	925 (437)	1050 (496)	1080 (510)	1200 (566)	1915(903)	1915(903)
Motor (HP) / Number of speeds	1/3 HP / 4 speeds			1/2 HP / 4 speeds		1 HP / 4 speeds	
Blower wheel size in(mm)	10 x 8 (254 x 203)			10 x 10 (254 x 254) (tight housing)		12 x 10 (304 x 254)	

Note 1 Without low firing baffle #3708

* INPUT & OUTPUT ADJUSTMENT

Pump pressure can be adjusted to maintain proper firing rate
 Increase pump pressure if flue gases' temperature is under 400°F
 Adjust the **total** flue gas temperature between 400°F and 575°F/330°F and 505°F **net** approx.)

Adjust fan speed for air temperature rise to be in specified range

** Default installed nozzle in bold character

*** AFUE value established after minimum 20 hours of continuous operation.

FURNACE SPECIFICATIONS

General Information			
Overall dimensions W x D x H - in(mm)	16-7/8" x 21-1/8" x 40-3/4" (429 x 537 x 1035)	21-3/4" x 25-3/4" x 41-1/2" (553 x 654 x 1054)	25" x 28-1/2" x 47-7/8" (635 x 724 x 1216)
Supply air opening - in(mm)	16" x 19" (406 x 483)	17-1/2" x 19" (445 x 483)	20" x 22" (508 x 559)
Return air opening - in(mm)	19" x 19" (483 x 483)	23" x 19" (584 x 483)	23" x 23" (584 x 584)
Filter size - in(mm)	20" x 20" (508 x 508)	24" x 20" x 1" (610 x 508 x 25)	24" x 24" x 1"
Shipping weight - lbs(kg)	125 (57)	153 (70)	200 (90)
Air conditioning, maximum output - tons	2.5	3.5	5.0

BLOWER PERFORMANCE DATA (Air delivery - with air filter)

OMF098

OMF098	External Static Pressure - in. w.c.									OMF098	External Static Pressure - Pa								
	0.1	0.2	0.3	0.4	0.5	0.6	0.7	0.8	0.9		25	50	75	100	125	149	174	199	224
Speed	CFM									Speed	L/s								
HIGH	1230	1185	1150	1095	1050	990	920	810	595	HIGH	580	559	543	517	496	467	434	382	281
MED-HIGH	1090	1055	1005	970	925	875	810	700	550	MED-HIGH	514	498	474	458	437	413	382	330	260
MED-LOW	865	860	860	845	795	745	695	600	460	MED-LOW	408	406	406	399	375	349	328	283	217
LOW	675	680	690	680	665	640	565	480	390	LOW	319	321	326	321	314	302	267	227	184

OMF112

OMF112	External Static Pressure - in. w.c.						OMF112	External Static Pressure - Pa					
	0.2	0.3	0.4	0.5	0.6	0.7		50	75	100	125	149	174
Speed	CFM						Speed	L/s					
HIGH	1550	1510	1460	1400	1320	1220	HIGH	731	713	689	661	623	576
MED-HIGH	1320	1280	1240	1200	1160	1020	MED-HIGH	623	604	585	566	547	481
MED-LOW	1180	1150	1110	1080	1040	940	MED-LOW	557	543	524	510	491	444
LOW	1070	1040	1010	980	910	840	LOW	505	491	477	462	429	396

OMF154

OMF154	External Static Pressure - in. w.c.						OMF154	External Static Pressure - Pa					
	0.2	0.3	0.4	0.5	0.6	0.7		50	75	100	125	149	174
Speed	CFM						Speed	L/s					
HIGH	2130	2085	1995	1915	1820	1745	HIGH	1005	984	941	904	859	824
MED-HIGH	1930	1855	1800	1750	1675	1615	MED-HIGH	911	875	849	826	790	762
MED-LOW	1565	1495	1460	1430	1400	1360	MED-LOW	739	706	689	675	661	642
LOW	1185	1170	1140	1105	1080	1065	LOW	559	552	538	521	510	503

ACCESSORIES

Model Number	Burners	Nozzle (supplied)	Model Number	Burners	Nozzle (supplied)
OMF098	N01J050 Beckett (chimney or direct)	(0.50 - 60W)	OMF112	N01J051 Riello (chimney)	(0.60-70A)
	N01J054 Riello (chimney)	(0.50 - 70A)		N01J052 Beckett (direct)	(0.60-70A)
	N01J055 Riello (direct)	(0.50 - 70A)	OMF154	N01J053 Beckett (chimney)	(0.75-60B)
		N01F056 Riello (direct)		(0.75-70A) (0.90-70A)	

ACCESSORY DESCRIPTION

Model No	Description
N01F051	Riello Burner (Chimney Vent) for OMF112
N01F052	Riello Burner (Direct Vent) for OMF112
N01F054	Riello Burner (Chimney Vent) for OMF098
N01F055	Riello Burner (Direct Vent) for OMF098
N01J050	Beckett NX Oil Burner for OMF098
N01J052	Beckett NX Oil Burner for OMF112
N01J053	Beckett NX Oil Burner for OMF154
DFB102	Downflow Subbase for OMF098
DFB103	Downflow Subbase for OMF112
DFB104	Downflow Subbase for OMF154
FRB101	Floor Return Base for OMF098
IFV520	5" Ø x 20' Insulated Flex Vent for 5" (127mm) Breech Models 20ft (6m) for OMF154
IFV09820	4" Ø x 20' (102mm x 6m) Insulated Flex Vent for 4" (102mm) Breech Models 20ft (6m)
VTK098	Vent Terminal Kit for 4"
VTK3	Vent Terminal Kit for 5"