

IMPACT RATED!

*Malco Hole Cutters are the longest lasting, fastest cutting solution for cutting holes in sheet metal.**
*based on internal testing

HC2
 2-20 in. (51-508 mm)
 Diameter Circles

HC1
 2-12 in. (51-305 mm)
 Diameter Circles

HC1 is adjustable for making 2 to 12 in. (51 to 305 mm) diameter holes. The larger HC2 model cuts 2 to 20 in. (51 to 508 mm) holes. A combination English / Metric diameter gauge is standard, and both quickly install into the chuck of any impact or drill as small as 1/4 in. (6.35 mm).

The Real Difference
Gold Standard Cutter Bits

Malco cutter bits feature a long lasting, mill type cutting edge and large flat for adjusting the cutting edge location up or down to extend bit life. One cutter bit fits either model and is easily replaceable. Available in single (CB), 6-pack (CBB), and 100-pack bulk tub (CB100).



Enlarged to show detail.



Specifications

Catalog Number	Description	Steel Type	Hole Diameter in. (mm)	Net Wt. oz. (g)
HC1	Hole Cutter	—	2-12 (50.8-304.8)	16 (454)
HC2	Hole Cutter	—	2-20 (50.8-508)	22 (624)
CB*	Mill Type Cutter Bit (Single)	HSS (High Speed)	—	—
CBB	Mill Type Cutter Bit (6 pack)	HSS (High Speed)	—	—
CB100	Mill Type Cutter Bit (100 tub)	HSS (High Speed)	—	—

Metal Capacities			
Material	Aluminum	Galvanized Steel 20 Gauge	Mild Steel 20 Gauge
inches (mm)	.054 (1.37)	.040 (1.02)	.036 (0.91)



CB (Single) **CBB** (6-pack) **CB100** (100-pack tub)



Perfect Circles

EVERY TIME!

Lightweight aluminum frames make Malco hole cutters extremely portable for a variety of holes in sheet metal including 20-gauge (1.02 mm) galvanized steel.

For Reference

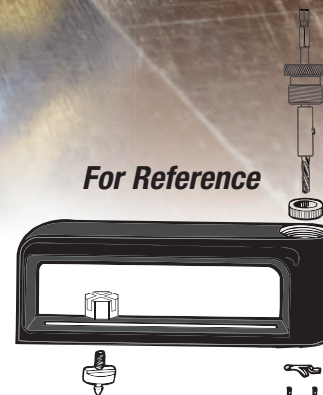

Replacement Parts

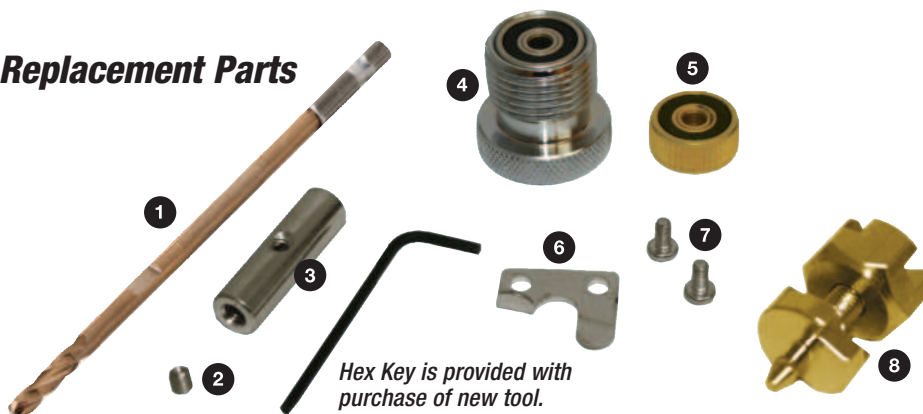

Hex Key is provided with purchase of new tool.

Replacement Parts

- | | |
|----|------------------------------------------------|
| 1. | CB - Cutter Bit |
| 2. | HC1H - Screw Only |
| 3. | HC1E - Adjustment Sleeve (with screw included) |
| 4. | HC1D - Thrust Bearing |
| 5. | HC1K - Bearing |
| 6. | HC1G - Shoe |
| 7. | HC1I - Shoe Screws |
| 8. | HC1B - Pivot Pin Set |