

PARTS AND ACCESSORIES

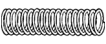
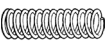

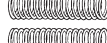

IMAGE	DESCRIPTION	MODEL NUMBER	ITEM NUMBER
	LP to Natural Gas Conversion Kit for Use On Single Stage 36C, D, E, F, G, H, J Valves, Regulation Range 2.5" to 5.0"W.C.	F92-0656	F0092 065600S1
	Natural to Regulated LP Gas Conversion Kit for Use On Single Stage 36C, D, E, F, G, H, J Valves. Regulation Range 7.0" to 12.0"W.C.	F92-0659	F0092 065900S1

IMAGE	DESCRIPTION	MODEL NUMBER	ITEM NUMBER
 	Natural to Regulated LP Gas Conversion Kit for Use On Two Stage 36G, H, J, Valves, Regulation Range 4.0" to 10.0"W.C. Low Fire, 6.0" to 12.0"W.C. High Fire	F92-1008	F0092 100800
 	Regulated LP to Natural Gas Conversion Kit for Use On Two Stage 36G, H, J, Valves, Regulation Range 1.0" to 4.0"W.C. Low Fire, 2.0" to 5.0" W.C. High Fire	F92-1011	F0092 101100

36H WIRING INFORMATION

SIMPLIFIED GAS VALVE INTERNAL WIRING AND TERMINAL IDENTIFICATION

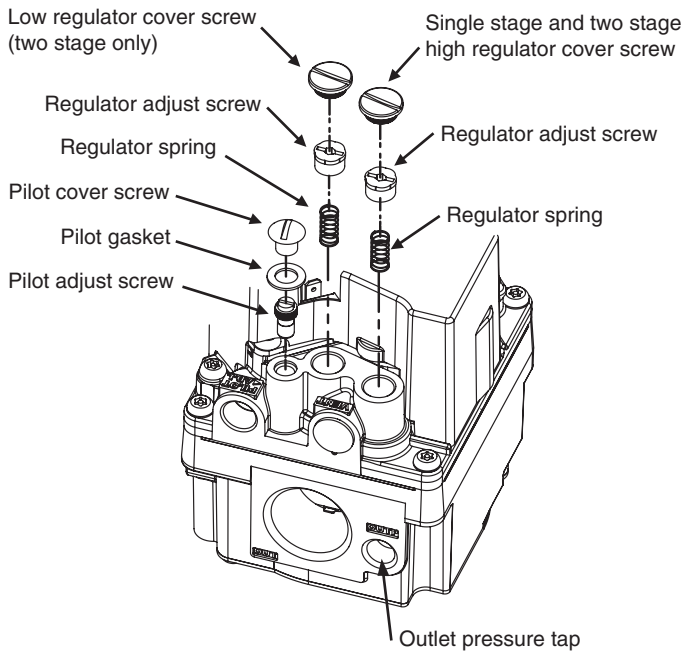

SINGLE AND TWO STAGE

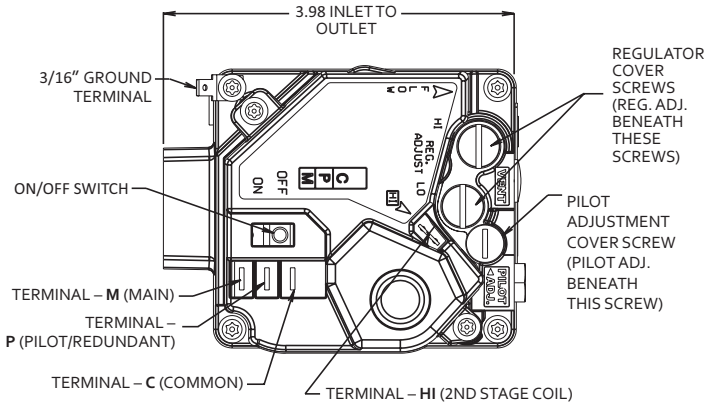

FEATURES AND TERMINAL IDENTIFICATION

