

Nylon Tee: Barb x Male Pipe Thread x Barb

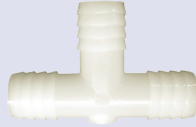

ITEM NO.	DESCRIPTION	STD QTY	CTN QTY	U M
TTB-161616	1/2" Barb x 1/2" MPT x 1/2" Barb	100	300	EA

Nylon Tee: Barb x Barb x Barb



ITEM NO.	DESCRIPTION	STD QTY	CTN QTY	U M
0646	1/4" Barb x 1/4" Barb x 1/4" Barb (5/Pk)	1	140	PK
0647	3/8" Barb x 3/8" Barb x 3/8" Barb (5/Pk)	1	120	PK
0600	1/2" Barb x 1/2" Barb x 1/2" Barb (4/Pk)	1	150	PK
TTA-161616	1/2" Barb x 1/2" Barb x 1/2" Barb	100	1800	EA
0622	1/2" Barb x 3/4" Barb x 1/2" Barb (2/Pk)	1	250	PK
0601	5/8" Barb x 5/8" Barb x 5/8" Barb (4/Pk)	1	125	PK
TTA-202020	5/8" Barb x 5/8" Barb x 5/8" Barb	50	1200	EA
0602	3/4" Barb x 3/4" Barb x 3/4" Barb (4/Pk)	1	90	PK
TTA-242424	3/4" Barb x 3/4" Barb x 3/4" Barb	50	750	EA

Clear Vinyl Tubing

- A clear, tough, flexible tubing
- Excellent for condensate drainage
- 23°F (-5°C) to 149°F (65°C) service temperature range
- 1/4", 3/8", & 1/2" tubing have a 21 PSI working & 58 PSI burst pressure
- 5/8", 3/4" & 7/8" tubing have a 14 PSI working & 43 PSI burst pressure

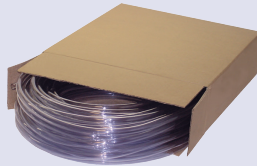

ITEM NO.	DESCRIPTION	STD QTY	PLT QTY	U M
5125	1/4" I.D. x 100' Roll	5	240	RL
5137	3/8" I.D. x 100' Roll	5	175	RL
5150	1/2" I.D. x 100' Roll	5	75	RL
5162	5/8" I.D. x 100' Roll	5	45	RL
5175	3/4" I.D. x 100' Roll	3	36	RL
5187	7/8" I.D. x 50' Roll	3	36	RL

Braided PVC Tubing

- Non-toxic clear PVC
- Synthetic braid reinforcement
- 23°F (-5°C) to 140°F (60°C) service temperature range
- 1/4" & 3/8" tubing has a 200 PSI working & 600 PSI burst pressure
- 1/2", 5/8", & 3/4" tubing have a 150 PSI working & 450 PSI burst pressure



ITEM NO.	DESCRIPTION	STD QTY	PLT QTY	U M
20626	1/4" I.D. x 50' Braided PVC Tubing	5	200	RL
20627	3/8" I.D. x 50' Braided PVC Tubing	5	160	RL
20628	1/2" I.D. x 50' Braided PVC Tubing	5	140	RL
20629	5/8" I.D. x 50' Braided PVC Tubing	5	60	RL
20630	3/4" I.D. x 50' Braided PVC Tubing	3	54	RL

Polyethylene Tubing

- Use tubing for ice makers & humidifiers
- -40°F to 135°F service temperature range



ITEM NO.	DESCRIPTION	STD QTY	CTN QTY	U M
5225	1/4" OD Polyethylene (100' Roll)	5	20	EA

Self-Tapping Water Valve

- Installs on all copper tube lines from 3/8" O.D. to 1-1/8" O.D.
- No drilling or shutting off water required
- 1/4" compression fitting
- Stainless steel piercing needle
- Molded gasket seals



ITEM NO.	DESCRIPTION	STD QTY	CTN QTY	U M
0131	Self-Tapping Water Valve	10	250	EA
0149	Self-Tapping Water Valve (Lead Free)	10	250	EA

Ice Maker Installation Kits

- For ice makers, humidifiers, evaporate coolers
- Contains "self-tapping valve", 1/4" tubing, & all necessary fittings
- Supplies water to refrigerators & humidifiers
- No drilling or shutting off water required



ITEM NO.	DESCRIPTION	STD QTY	U M
0130	25' Polyethylene Tubing Kit	20	KT
0148	25' Lead Free Polyethylene Tubing Kit	20	KT
17499	25' Copper Tubing Kit	1	KT