

QUICK COUPLERS Expanded line

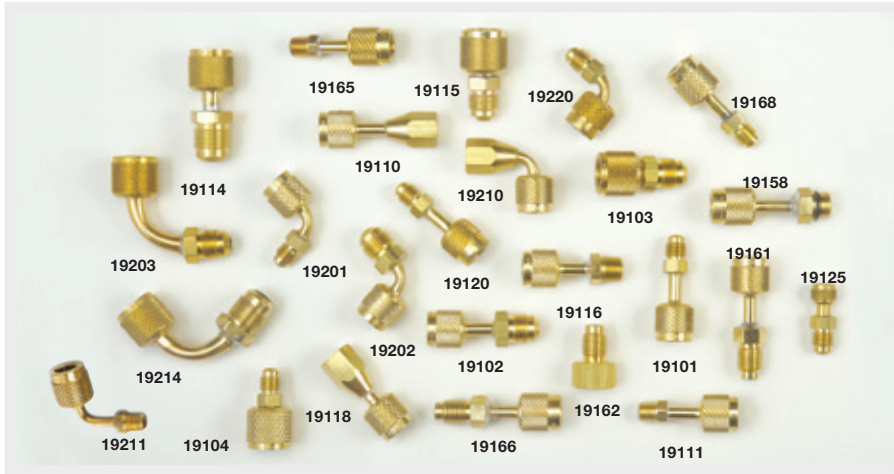

- Full size with deep knurling for easy handling
- CH14 “Adjust-a-Valve” opener in all 1/4" Female ends
- Acme conversion couplers are available for recovery tank threads and R-134A cylinder threads
- 5/16" Conversion couplers available
- Made in the USA

| UPC# | Description |
|--------------------------------|---|
| Straight quick couplers | |
| 19125 | 1/8" Female QC x 1/4" Male flare (Ford) |
| 19120 | 3/16" Female QC x 1/4" Male flare (GM) |
| 19101 | 1/4" Female QC x 1/4" Male flare |
| 19102 | 1/4" Female QC x 3/8" Male flare |
| 19111 | 1/4" Female QC Str. x 1/8" NPT Male |
| 19116 | 1/4" Female QC Str. x 1/4" NPT Male |
| 19103 | 3/8" Female QC x 3/8" Male flare |
| 19104 | 3/8" Female QC x 1/4" Male flare |
| 19115 | 1/2" Female QC x 3/8" Male flare |
| 19114 | 3/8" Female QC x 1/2" Male flare |
| 19020 | Gaskets (10 pk) |

| UPC# | Description |
|---------------------------|---------------------------------------|
| 90° Quick couplers | |
| 19220 | 3/16" Female QC 90° x 1/4" Male flare |
| 19201 | 1/4" Female QC 90° x 1/4" Male flare |
| 19202 | 1/4" Female QC 90° x 3/8" Male flare |
| 19203 | 3/8" Female QC 90° x 3/8" Male flare |
| 19214 | 3/8" Female QC 90° x 1/2" Male flare |

| UPC# | Description |
|---|------------------------------------|
| Gauge quick couplers with CH14 adjustable valve opener | |
| 19110 | 1/4" Female QC x 1/8" NPT Fe. |
| 19118 | 1/4" Female QC Str. x 1/4" NPT Fe. |
| 19210 | 1/4" Female QC 90° x 1/8" NPT Fe. |
| 19218* | 1/4" Female QC 90° x 1/4" NPT Fe. |

| UPC# | Description |
|---|---------------------------------|
| 5/16" Quick couplers with CH14 adjustable valve opener | |
| 19121* | 5/16" QC Str. x 1/4" Male flare |
| 19221* | 5/16" QC 90° x 1/4" Male flare |
| 19122* | 1/4" QC Str. x 5/16" Male flare |
| 19222* | 1/4" QC 90° x 5/16" Male flare |

| UPC# | Description |
|---|---|
| ACME 1/2" couplers – auto straight | |
| 19161 | 1/4" Female QC x 1/2" Acme Male |
| 19162 | 1/4" Female hex x 1/2" Acme Male for permanent applications |
| 19166 | 1/2" Acme Male x 1/2" Acme Female |
| 19165 | 1/2" Acme Female x 1/4" Male flare |
| 19168 | 1/2" Acme Female x 1/8" NPT Male |
| 19158 | 1/2" Acme Female x 14 mm Male |
| 19164 | Quick Coupler ACME X 1/4 MPT |

QUICK COUPLERS Schrader core in male end



- All couplers have Schrader valve cores in Male flare end
- Female coupler end has deep knurling for easy handling
- Patented CH14 “Adjust-a-Valve” opener in all 1/4" Female ends
- Made in the USA

| UPC# | Description |
|--------------------------------|----------------------------------|
| Straight quick couplers | |
| 19171 | 1/4" Female QC x 1/4" Male flare |
| 19172 | 3/8" Female QC x 1/4" Male flare |

| UPC# | Description |
|--------------------------------|----------------------------------|
| 90° Bend quick couplers | |
| 19191 | 1/4" Female QC x 1/4" Male flare |
| 19192 | 3/8" Female QC x 1/4" Male flare |

| UPC# | Description |
|----------------------------|------------------------------------|
| 45° R-410A couplers | |
| 19173 | 5/16" Female QC x 1/4" Male flare |
| 19174 | 1/4" Female QC x 5/16" Male flare |
| 19175 | 5/16" Female QC x 5/16" Male flare |

SEALRIGHT™ QUICK COUPLERS



SealRight™ fittings automatically and immediately trap refrigerant in the hose when disconnected, helping meet non-venting regulations and preventing finger burns. One-piece attaches quickly, saving up to 50 percent in time compared to 2-piece quick couplers.

- Works with or without Schrader core
- Gaskets resist deterioration from SealRight repair assembly components
- CFC, HCFC, HFC refrigerants and refrigerant oils. Field serviceable
- Made in the USA

| UPC# | Description |
|-------|--|
| 19109 | 1/4" SealRight™ Str. x 1/4" Male flare |
| 19208 | 1/4" SealRight™ 45° x 1/4" Male flare |
| 19209 | 1/4" SealRight™ 90° x 1/4" Male flare |
| 19100 | Set of 19109 and 19209 |
| 19117 | 1/4" SealRight™ Str. x 3/8" Male flare |
| 19217 | 1/4" SealRight™ 90° x 3/8" Male flare |
| 19128 | 1/4" SealRight™ Str. x 1/8" NPT Female |
| 19129 | 1/4" SealRight™ Str. x 1/4" NPT Female |
| 19169 | Acme 1/2" SealRight™ x 1/2" Acme |
| 19163 | Acme 1/2" SealRight™ x 1/4" Male flare |

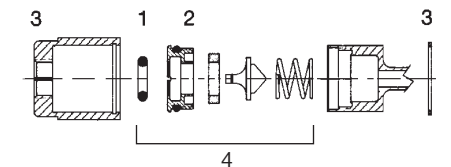

| UPC# | Description |
|---|-----------------------------------|
| SealRight repair assembly components | |
| 19037 | “O” rings (10 pak) (1) |
| 19038 | Plug assembly with all seals (2) |
| 19039 | Nut and clip (3) |
| 19040 | Rebuild kit (4) |
| 19041 | Overhaul kit with all above parts |
| 19045 | Gasket set |